

PARTS LIST - XG-24VNR
 BOLT KIT - XG-BRK23 & XG-BRK40
 COMPATIBLE GUARDS

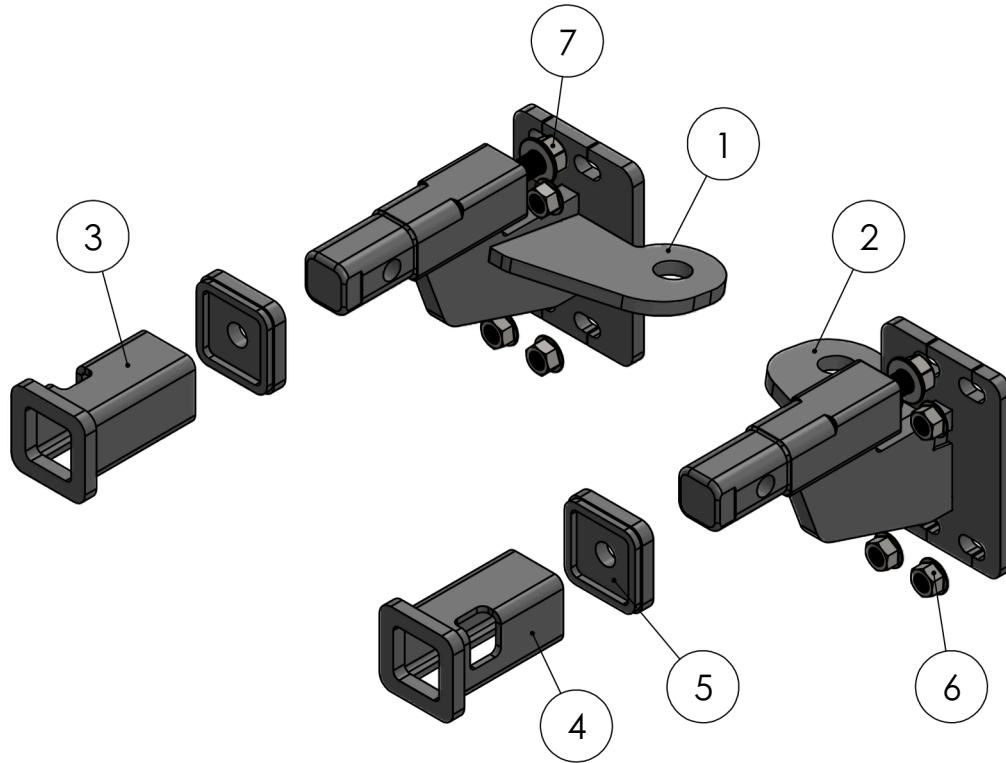

CALL: (888) 902-2777 FOR INSTALLATION QUESTIONS OR EMAIL: INFO@EX-GUARD.COM

- Check <https://ex-guard.com/>



ITEM NO.	PART NUMBER	DESCRIPTION	QTY.
1	XG-24VNR-BR10DR	MOUNTING BRACKET DR	1
2	XG-24VNR-BR10PS	MOUNTING BRACKET PS	1
3	XG-24VNR-BR04SADR	BRACKET SUPPORT ASSEMBLY	1
4	XG-24VNR-BR04SAPS	BRACKET SUPPORT ASSEMBLY	1
5	XG-24VNR-BR06SA	RECIEVER SUPPORT PLATE ASSEMBLY	2
6	XG-001-62-11FHHNL5Z	5/8-11 FLANGE PATCH HEX NUT	8
7	XG-001-75-16FHHNTLGZ	3/4"-16 FLANGE HEX HEAD TOP LOCK NUT	2



ATTENTION!! Any Ex-Guard grille guard, bracket kit, or hardware must be used with corresponding Ex-Guard components. Use of any other product or brand with Ex-Guard products will immediately void the warranty provided by Ex-Guard Industries.

XG-24VNR Installation Instructions

1. Locate Receiver Openings

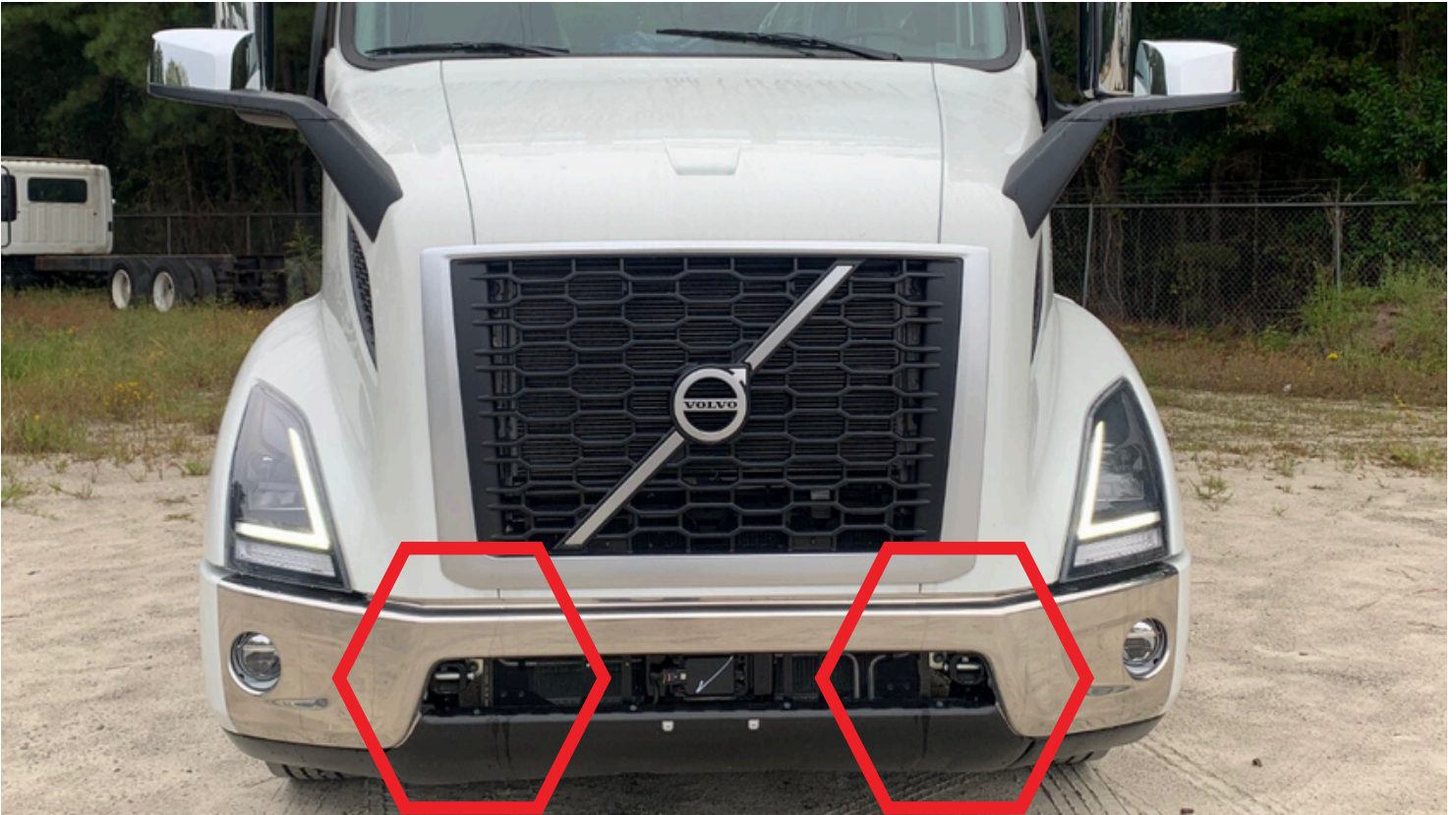

2. Take Retainer Pin Out Of The PS Tow Hook Receiver

3. Take The PS Bracket Support Assembly and Line It Up With The PS Tow Hook Receiver (With Notch Facing Outwards)



4. Put The PS Mounting Bracket Through Bracket Support Assembly And Into The PS Receiver



****If There Is Not Enough Clearance Between The Bumper And Receiver: Take Out The Mounting Brackets, Open The Hood, Loosen The Four Bolts Shown, Slide The Bumper Forward, And Re-tighten. Do It On Whichever Side Needs It.****



5. Put The Retainer Pin Through The DR Bracket Assembly (1) To Lock It In Place



6. Take The Receiver Support Plate Assembly And Put It On The Exposed Bolt On The PS Mounting Bracket Assembly



7. Put The Nut On After The Receiver Support Plate Assembly And Tighten To Hold It In Place

8. Repeat Steps 3-7 For PS

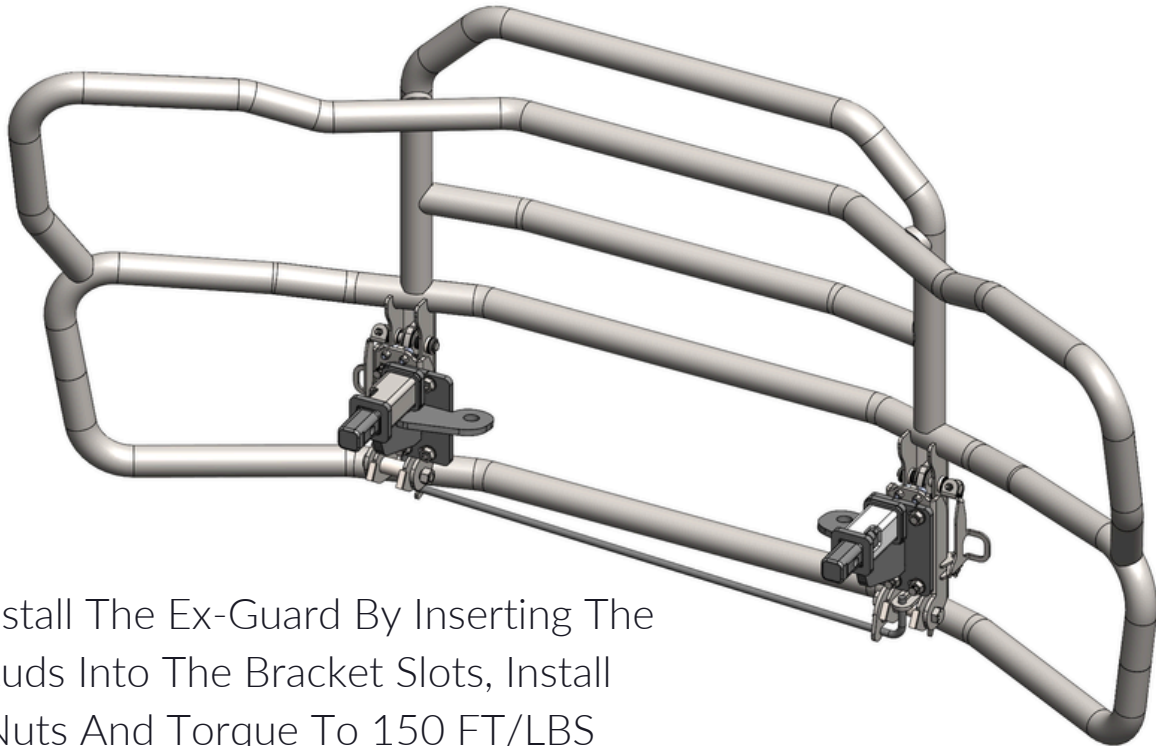

9. Install The Ex-Guard By Inserting The Studs Into The Bracket Slots, Install Nuts And Torque To 150 FT/LBS

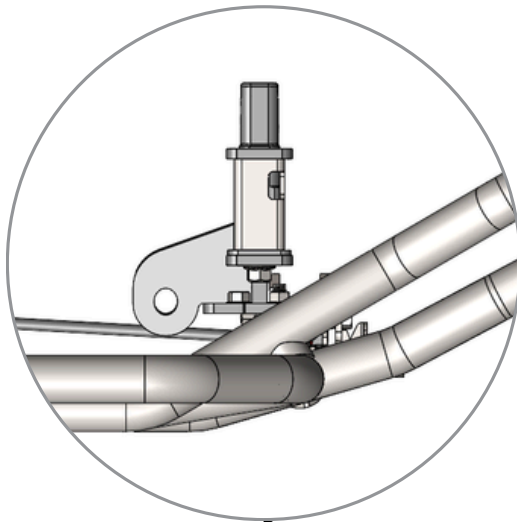

The Bracket Support Assembly Notches Are On The Top And Facing Outwards.

