

## PARTS LIST - XG-26VNR

### BOLT KIT - XG-BRK38

### COMPATIBLE GUARDS

- Check <https://ex-guard.com/>

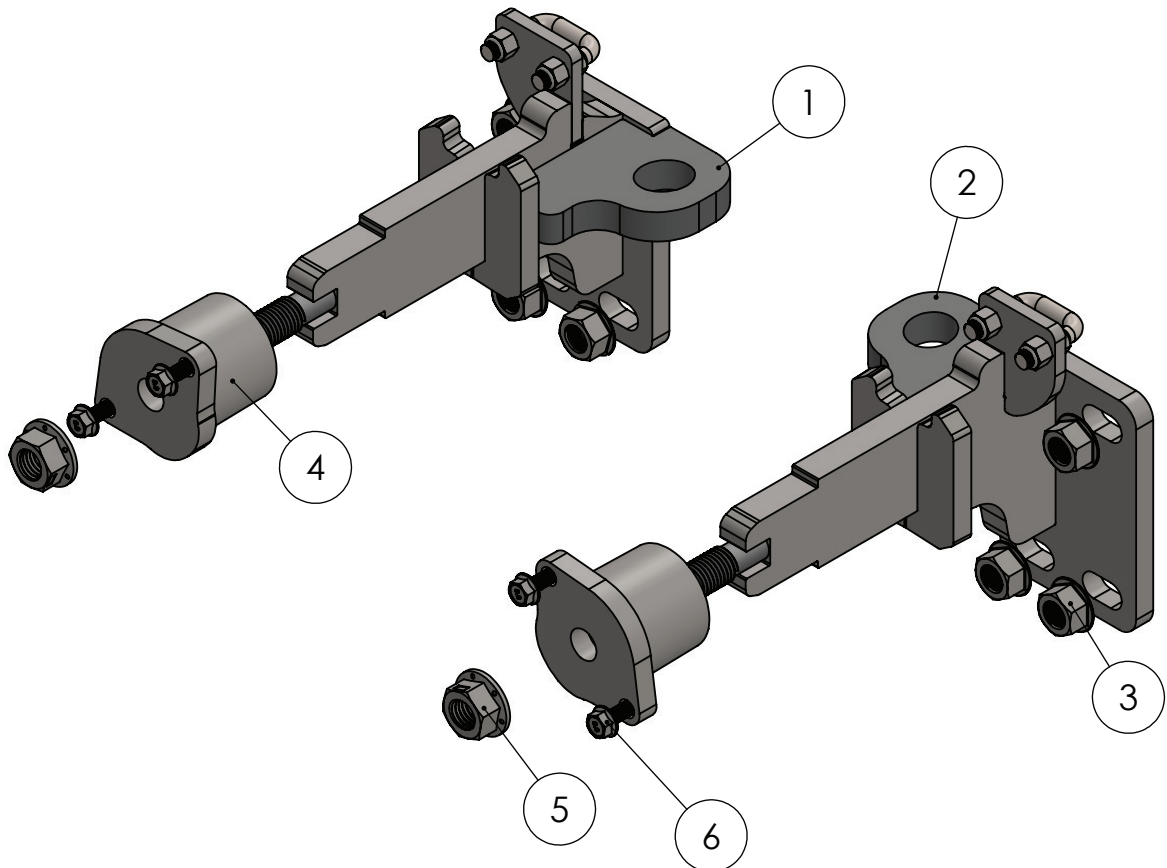

ITEM NO.	PART NUMBER	DESCRIPTION	QTY.
1	XG-26VNR-BR10DR	DRIVER SIDE MOUNTING BRACKET	1
2	XG-26VNR-BR10PS	PASSENGER SIDE MOUNTING BRACKET	1
3	XG-001-62-11FHHNL5Z	5/8-11 FLANGE PATCH HEX NUT	6
4	XG-26VNL-BR07SA	26VNL DRIVER SIDE RECIEVER SUPPORT ASSEMBLY	2
5	XG-001-75-10FHHNAL8ZY	3/4\"-10 FLANGE HEX AUTO LOCKNUT	2
6	XG-001-M8-1.25FHHC308.8Z	M8X30MM FLANGE HEX HEAD CAPSCREW	4

**ATTENTION!!** Any Ex-Guard grille guard, bracket kit, or hardware must be used with corresponding Ex-Guard components. Use of any other product or brand with Ex-Guard products will immediately void the warranty provided by Ex-Guard Industries.



CALL: (888) 902-2777 FOR INSTALLATION QUESTIONS OR EMAIL: [INFO@EX-GUARD.COM](mailto:INFO@EX-GUARD.COM)



**STEP 1:**  
Locate receiver covers  
and remove on both sides.



**STEP 2:**  
Open the hood of the truck.









**STEP 5:**  
Insert passenger-side  
bracket piece.



**STEP 5:**  
Insert passenger-side  
bracket piece.



**STEP 6:**  
Apply thread lock to  
both bolts.





**STEP 9:**  
Repeat steps 3-8 on  
driver-side.

**STEP 10:**  
Close the hood.

**STEP 11:**  
Insert both brackets.

**STEP 11:**  
Insert both brackets.

**STEP 11:**  
Insert both brackets.

**STEP 12:**  
**Open the hood.**

**STEP 13:**  
**Install flange nuts**  
**leaving 1/8" thread exposed.**



**STEP 14:**  
**Close the hood.**



**STEP 15:**  
**Install Ex-Guard.**  
**Torque nuts to 225 ft-lb.**







**STEP 16:**  
Lower guard and  
open the hood.



**STEP 17:**  
Torque bracket nut to  
250 ft-lb. Repeat on other side.



**STEP 17:**  
Torque bracket nut to  
250 ft-lb. Repeat on other side.



