

PARTS LIST - MB-19HX-GM15

BOLT KIT - MB-BRK5

COMPATIBLE GUARDS

- Check <https://ex-guard.com/>

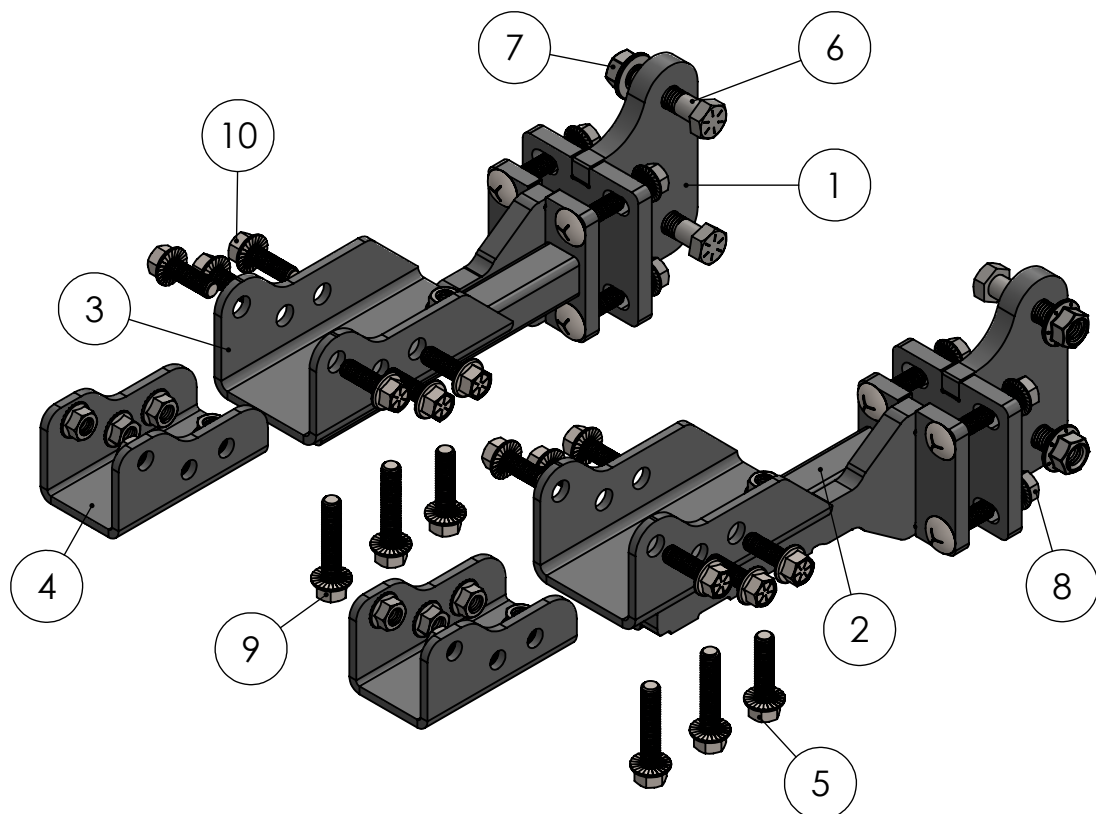

ITEM NO.	PART NUMBER	DESCRIPTION	QTY.
1	MB-19HX-GM15-BR06SA	GUARD MOUNT ASSEMBLY	2
2	MB-19HX-GM15-BR02SA	RECIEVER BRACKET	2
3	MB-19HX-GM15-BR01SA	FRAME SUPPORT PLATE WITH NUT ASSMEBLY	2
4	MB-19HX-GM15-BR04SA	FRAME SUPPORT PLATE WITH NUTS ASSEMBLY	2
5	XG-001-50-13SFHHC2008ZY	1/2"-13 X 2" SERRATED FLANGE HEX HEAD CAPSCREW	2
6	XG-001-62-11HHC2508ZY	5/8-11 X 2 1/2" HEX HEAD CAPSCREW	4
7	XG-001-62-11FHHNTL8ZY	5/8"-11 TOP LOCK FLANGE HEX NUT GRADE 8 YELLOW ZINC PLATED STEEL	4
8	XG-001-50-13SFHHN8ZY	1/2"-13 SERRATED FLANGE HEX NUT	8
9	XG-001-50-13SFHHC2508ZY	1/2"-13 X 2 1/2" SERRATED FLANGE HEX HEAD CAPSCREW	4
10	XG-001-50-13SFHHC1508ZY	1/2"-13 X 1 1/2" SERRATED FLANGE HEX HEAD CAPSCREW	12

ATTENTION!! Any Ex-Guard grille guard, bracket kit, or hardware must be used with corresponding Ex-Guard components. Use of any other product or brand with Ex-Guard products will immediately void the warranty provided by Ex-Guard Industries.



CALL: (888) 902-2777 FOR INSTALLATION QUESTIONS OR EMAIL: INFO@EX-GUARD.COM



MB-19HX-GM15 Installation Instructions

1



TOOLS NEEDED:

- 18mm Wrench & Socket**
- 15/16 Wrench & Socket**
- 3/4 Wrench & Socket**
- Torque Wrench**

2

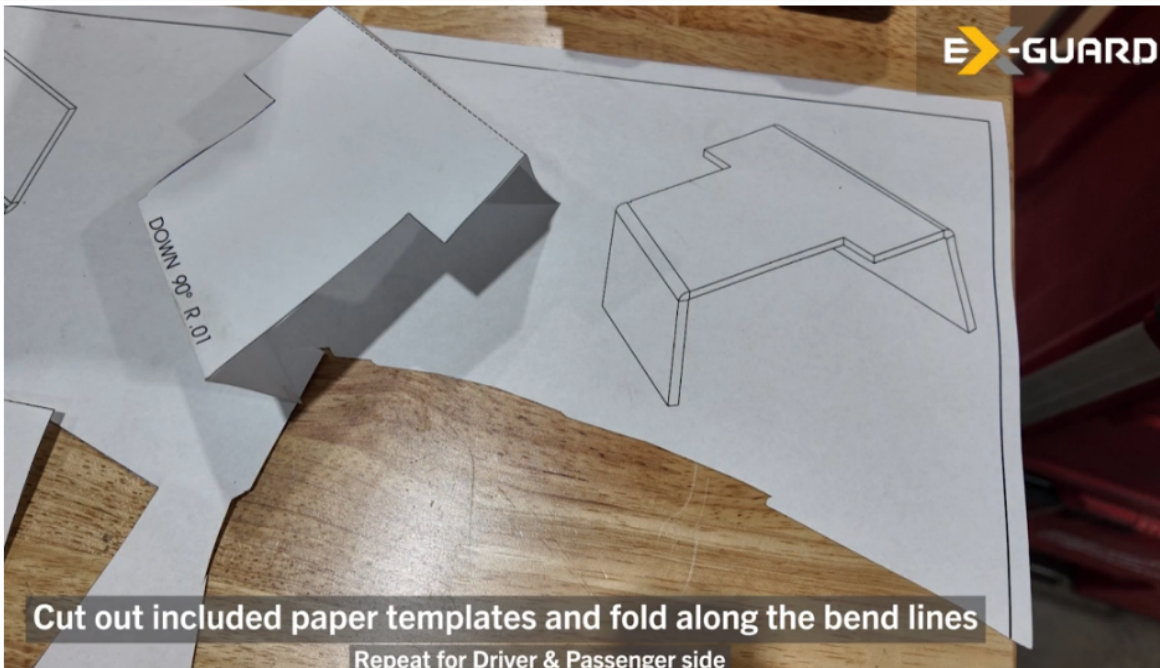

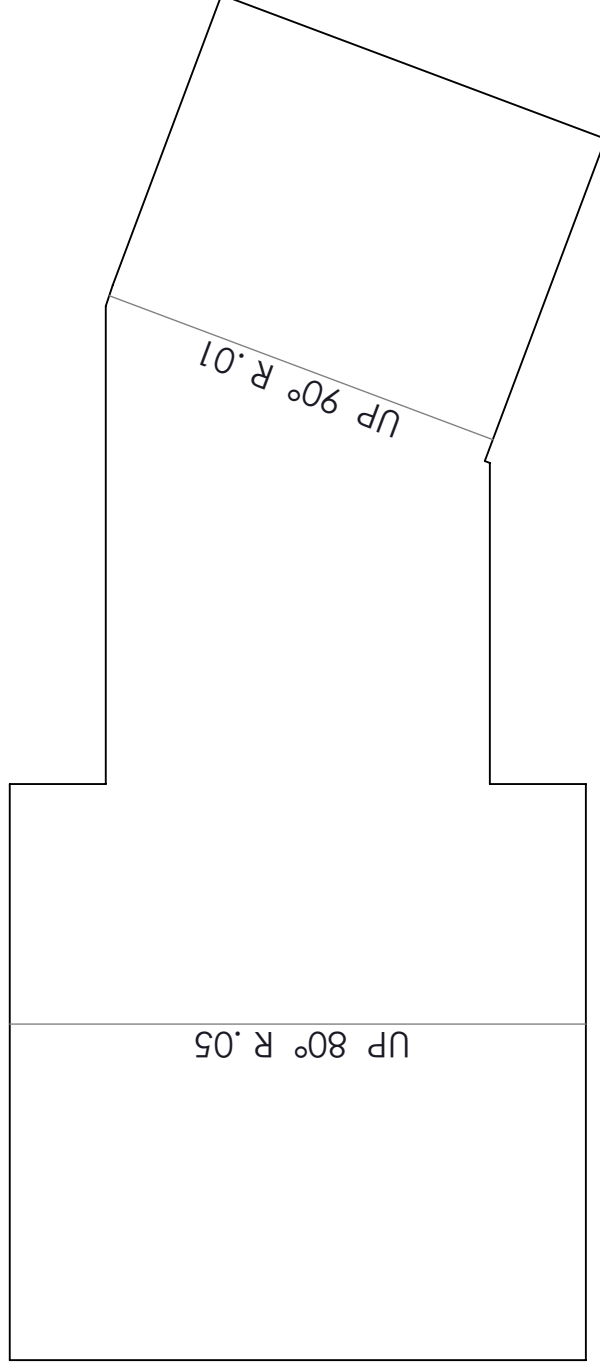

MB-19HX-GM15 CUTOUT TEMPLATE

ISSUED BY:



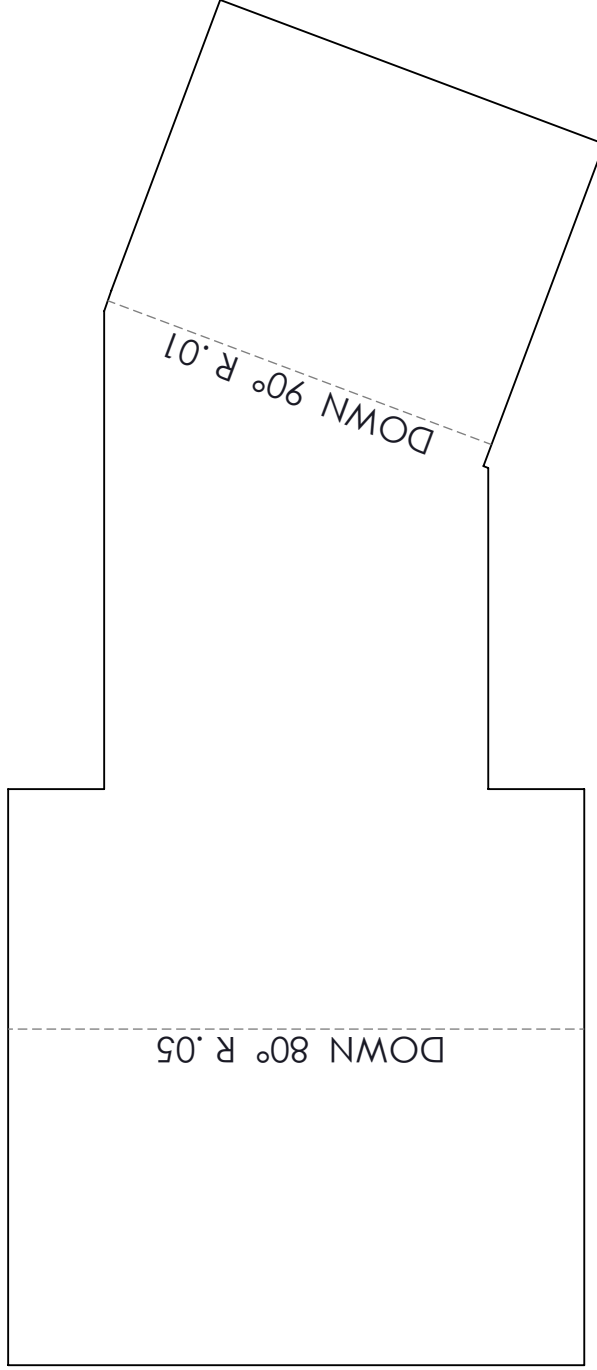

MB-19HX-GM15 CUTOUT TEMPLATE

ISSUED BY:



3

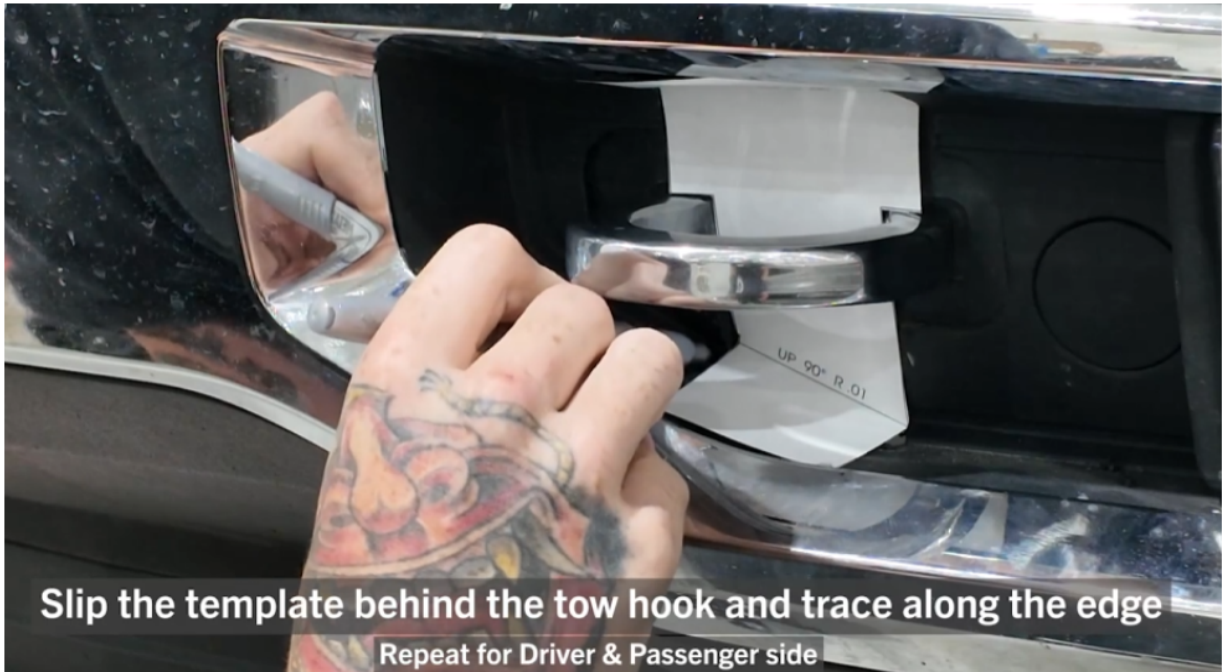

4

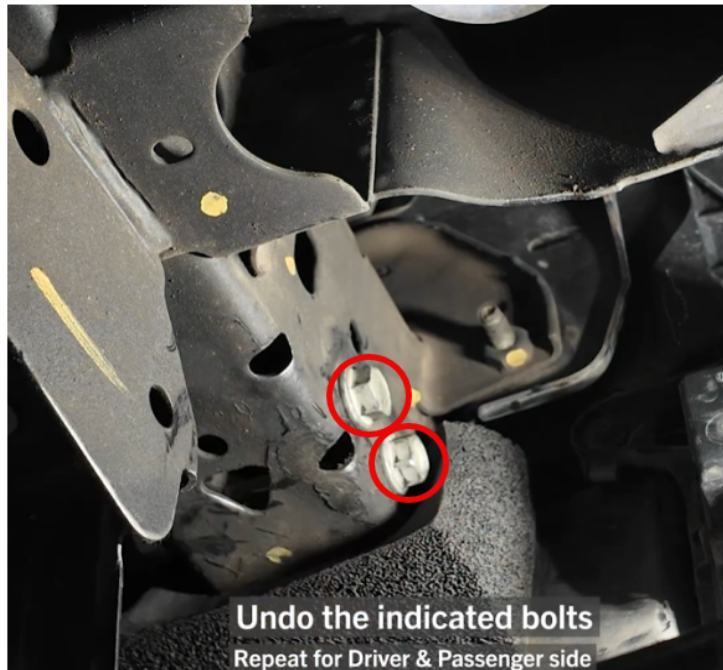

5

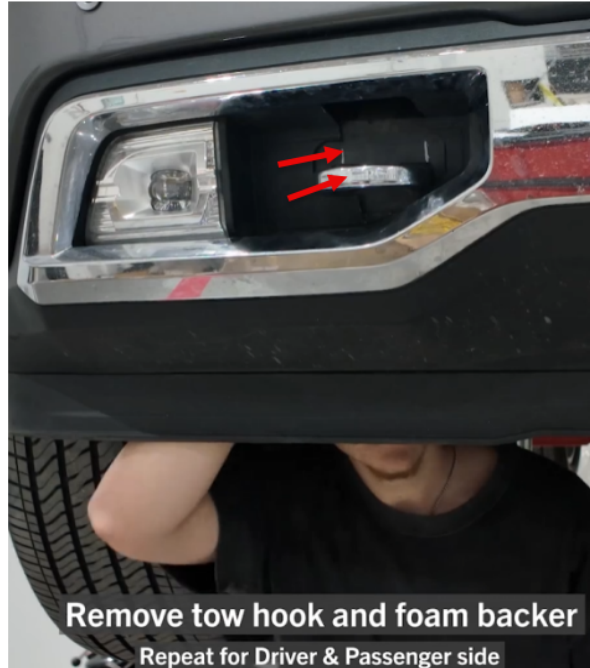

6



7



8

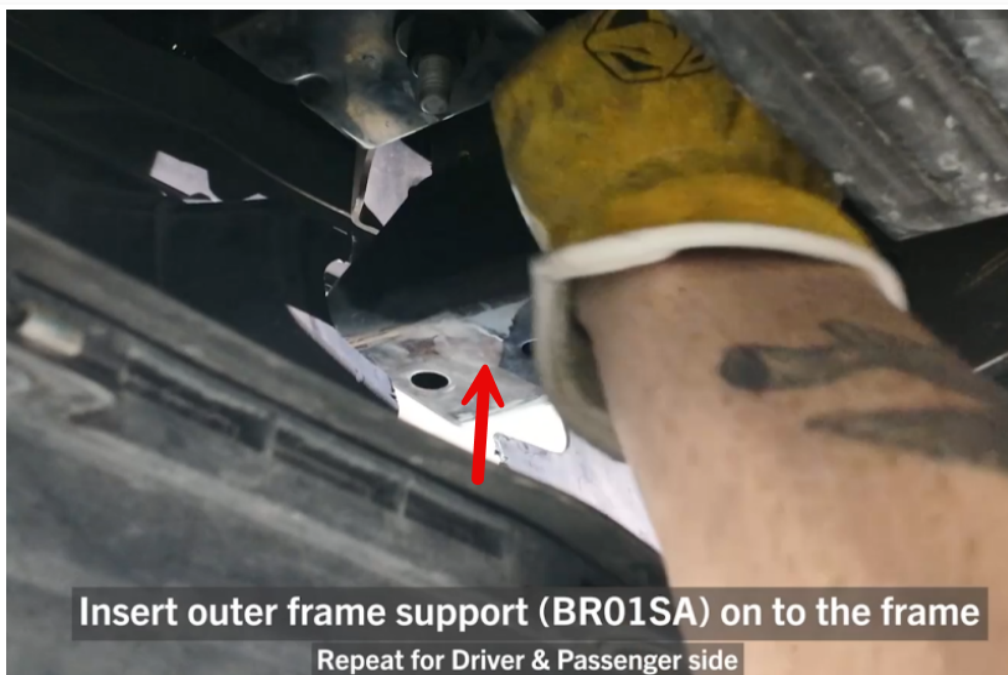

9



Align and insert the bottom 2 bolts

Repeat for Driver & Passenger side

10

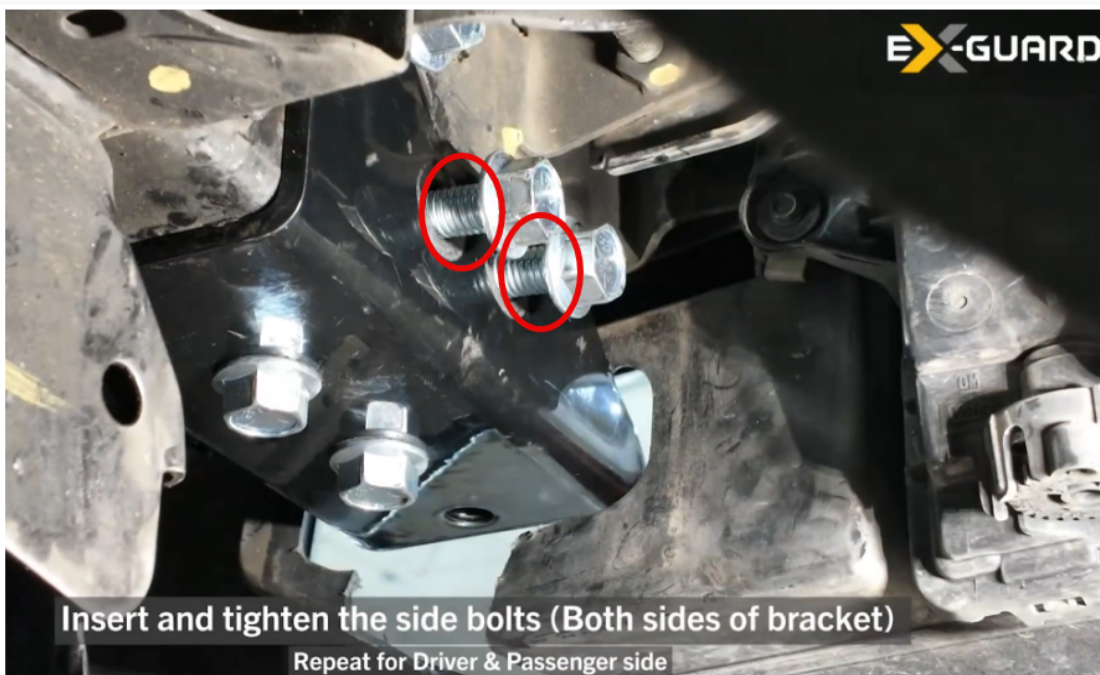

Insert and tighten the side bolts (Both sides of bracket)

Repeat for Driver & Passenger side

11

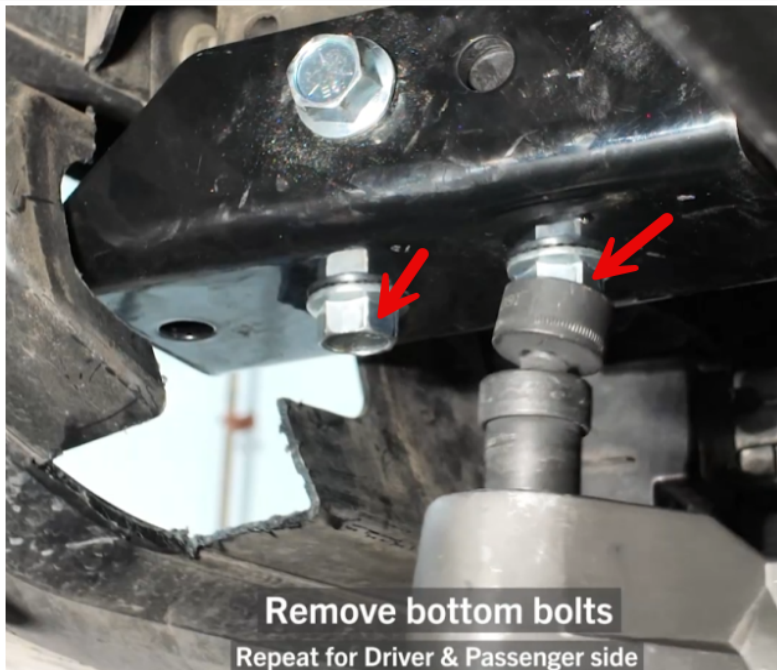

Remove bottom bolts
Repeat for Driver & Passenger side

12



Attach the receiver bracket (BR02SA) using the indicated bolts
Repeat for Driver & Passenger side

13

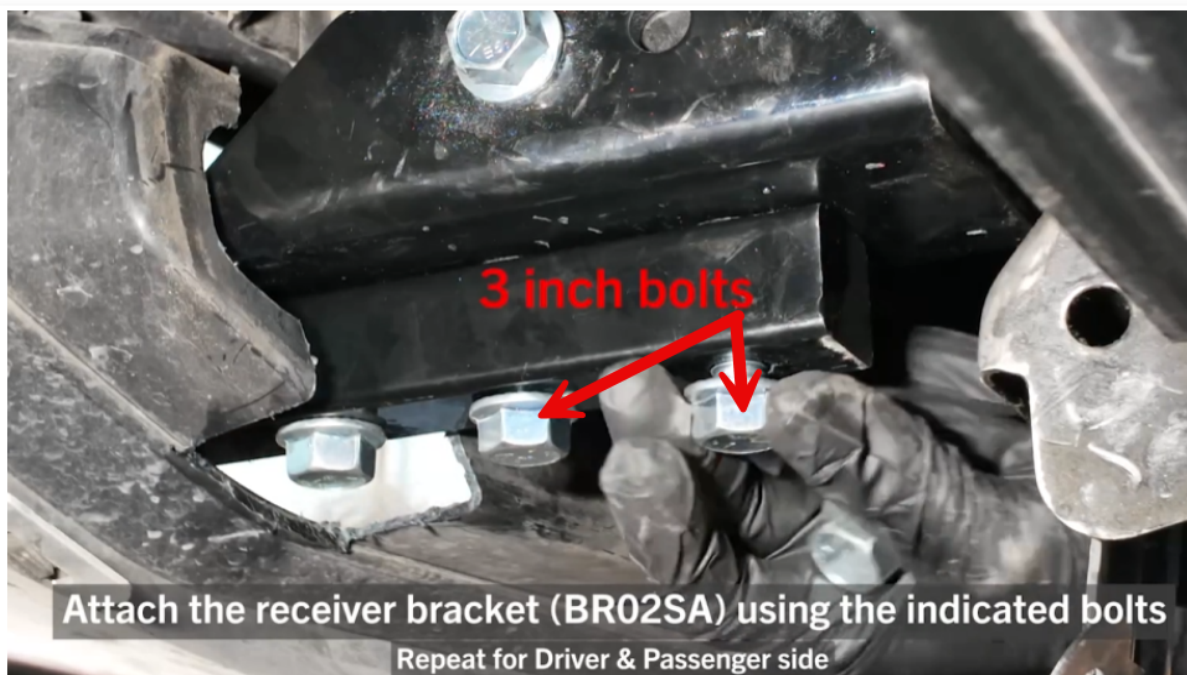

14



15

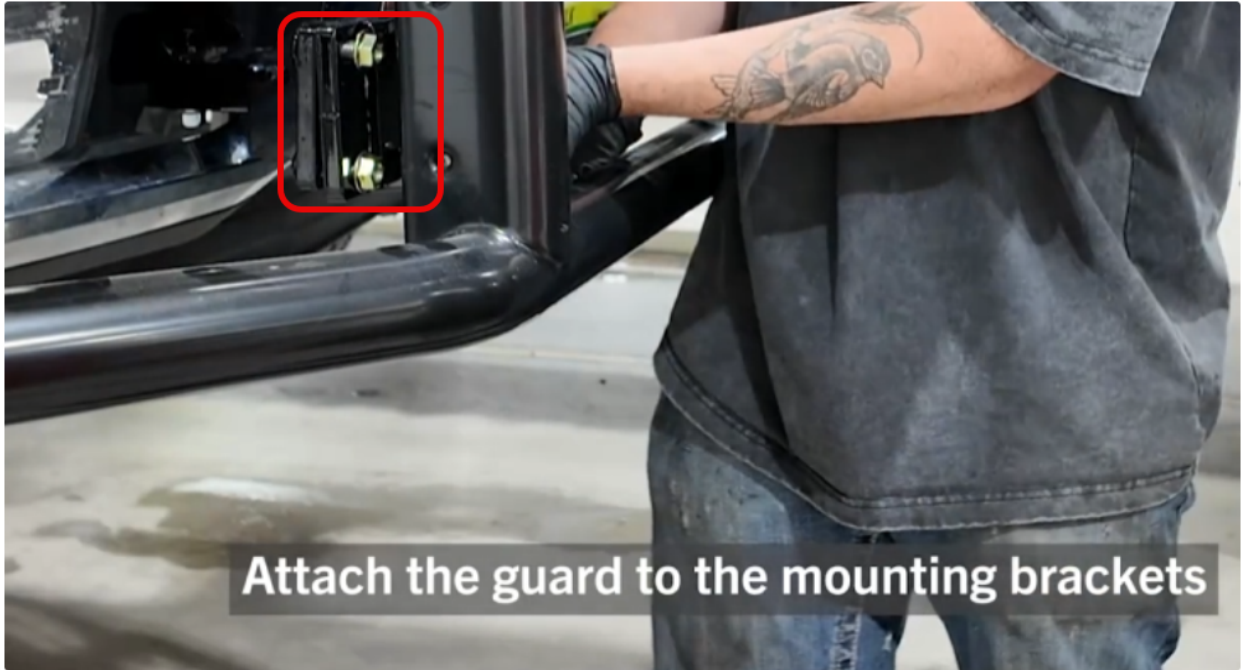

Attach the guard to the mounting brackets

16

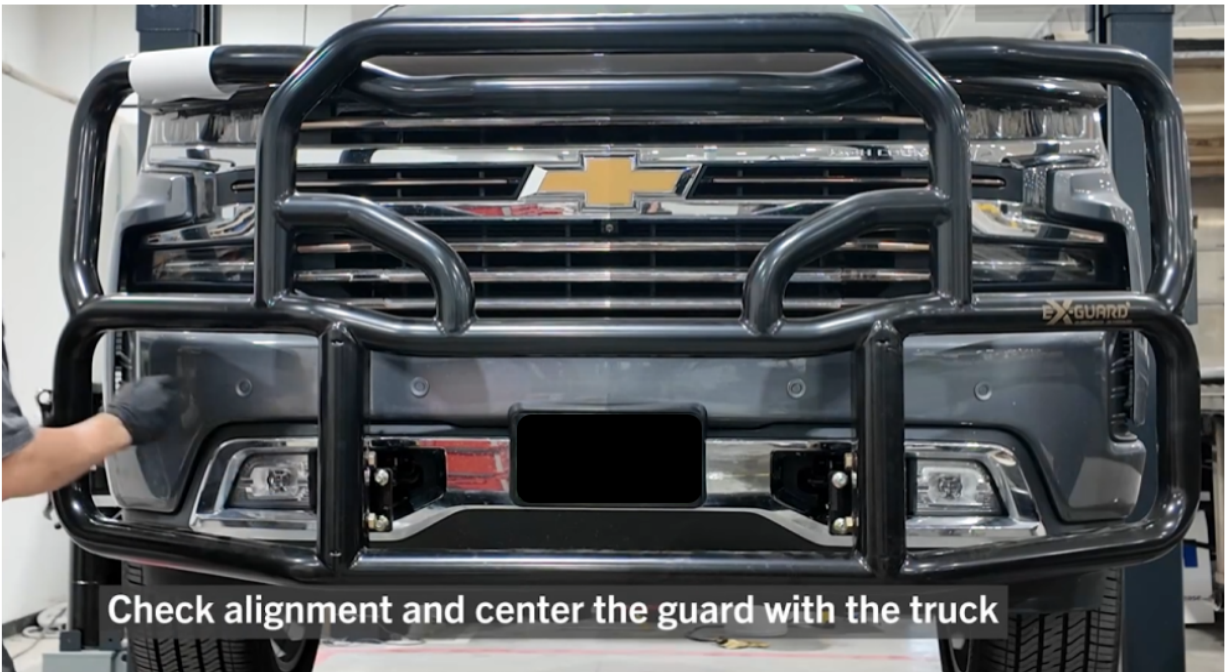

Check alignment and center the guard with the truck

17



18



DRIVE SAFE!

