



# CV-19MSP-BR10

INSTALLATION INSTRUCTIONS

**EX-GUARD®**

888.902.2777

CUSTOMERCARE@EX-GUARD.COM  
EX-GUARD.COM

# PARTS LIST - CV-19MSP MT

## COMPATIBLE GUARDS

- Check <https://ex-guard.com/>

CALL FOR (888) 902-2777 FOR INSTALLATION QUESTIONS OR EMAIL INFO@EX-GUARD.COM

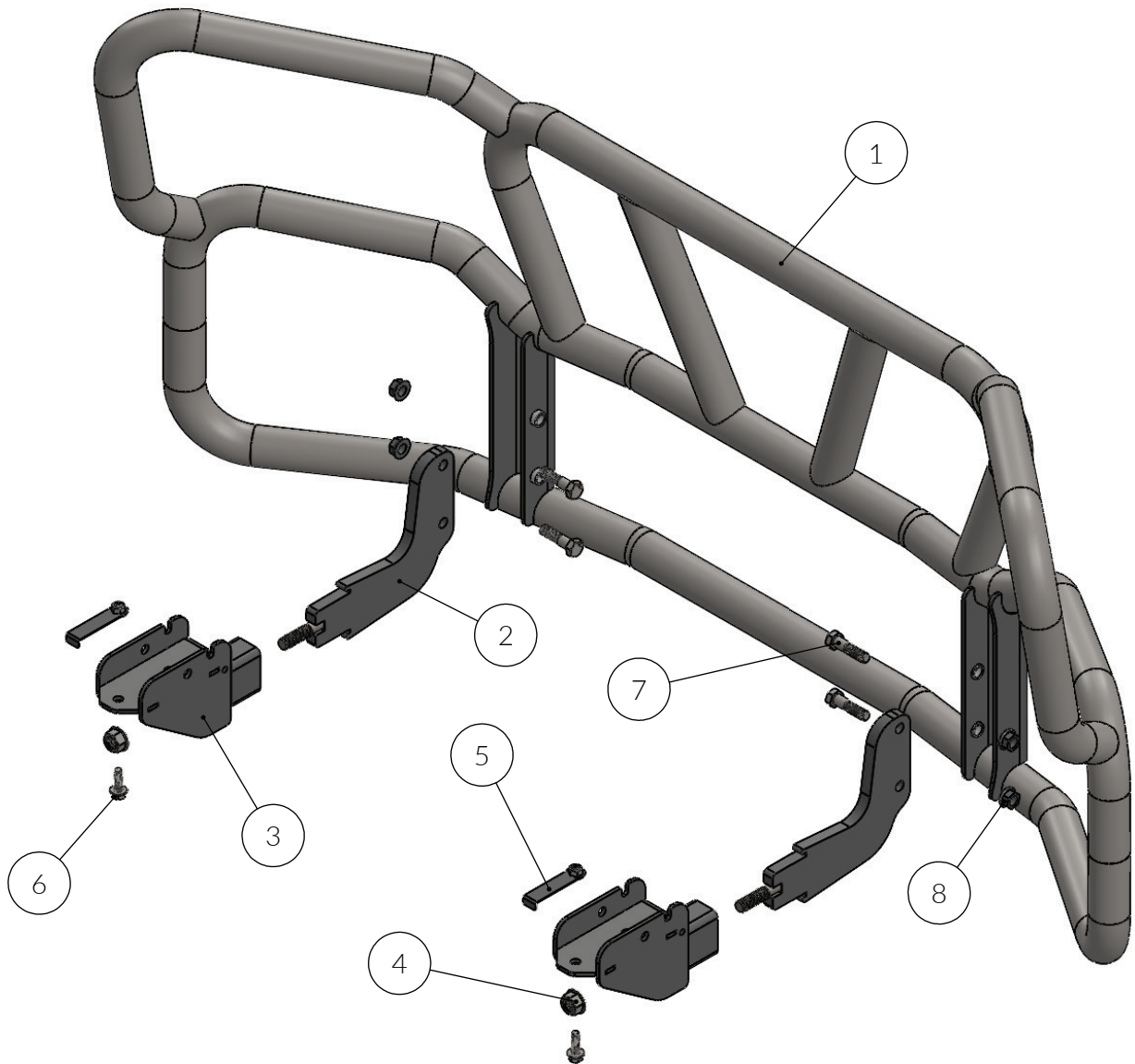

ITEM NO.	PART NUMBER	DESCRIPTION	QTY.
1	CV-19MSP-50	CV GUARD	1
2	CV-19MSP-BR03SA	MOUNT INSERT	2
3	CV-19MSP-BR10	MOUNTING BRACKET	2
4	XG-001-75CNWFOY	3/4X16 AUTO FLG LOCKNUT	2
5	CV-19MSP-BR06SA	WRENCH ASSEMBLY	2
6	XG-001-12C35SHFWZ	M12X1.75MMX35MM HEX HEAD	2
7	XG-001-62C250HCS8Y	5/8-11X2 1/2" HEX CAP GR8 Z&Y	4
8	XG-001-62CNWFOZ_HARD	5/8-11 SERR FLG HEX HEAD HARD ZINC	4

ATTENTION!! Any Ex-Guard grille guard, bracket kit, or hardware must be used with corresponding Ex-Guard components. Use of any other product or brand with Ex-Guard products will immediately void the warranty provided by Ex-Guard Industries.



18-1/4" from center

Drivers side

36-1/2" cutout to cutout

2.2318

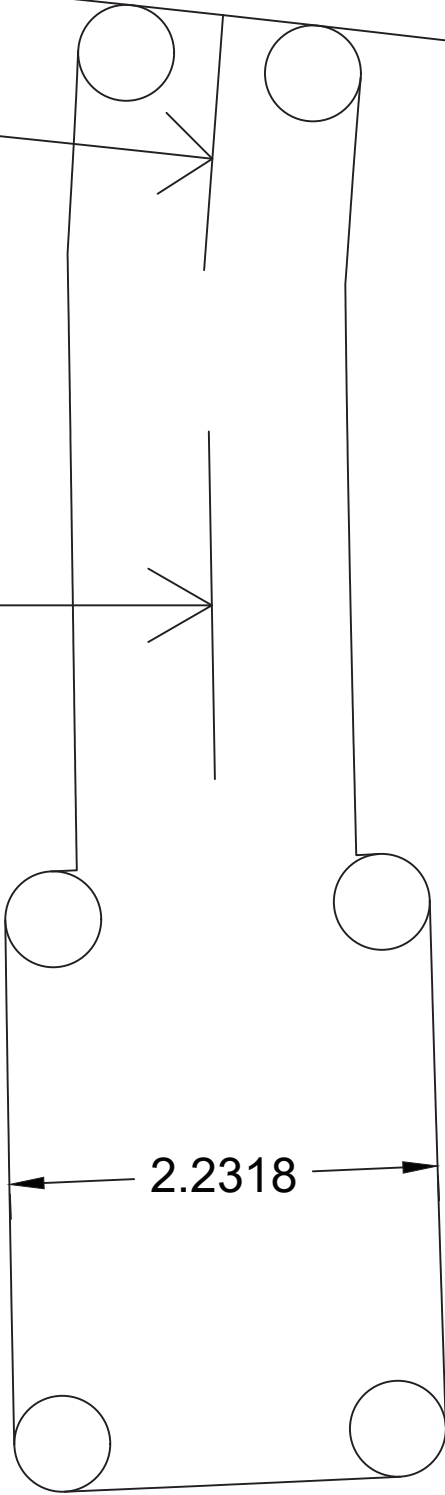

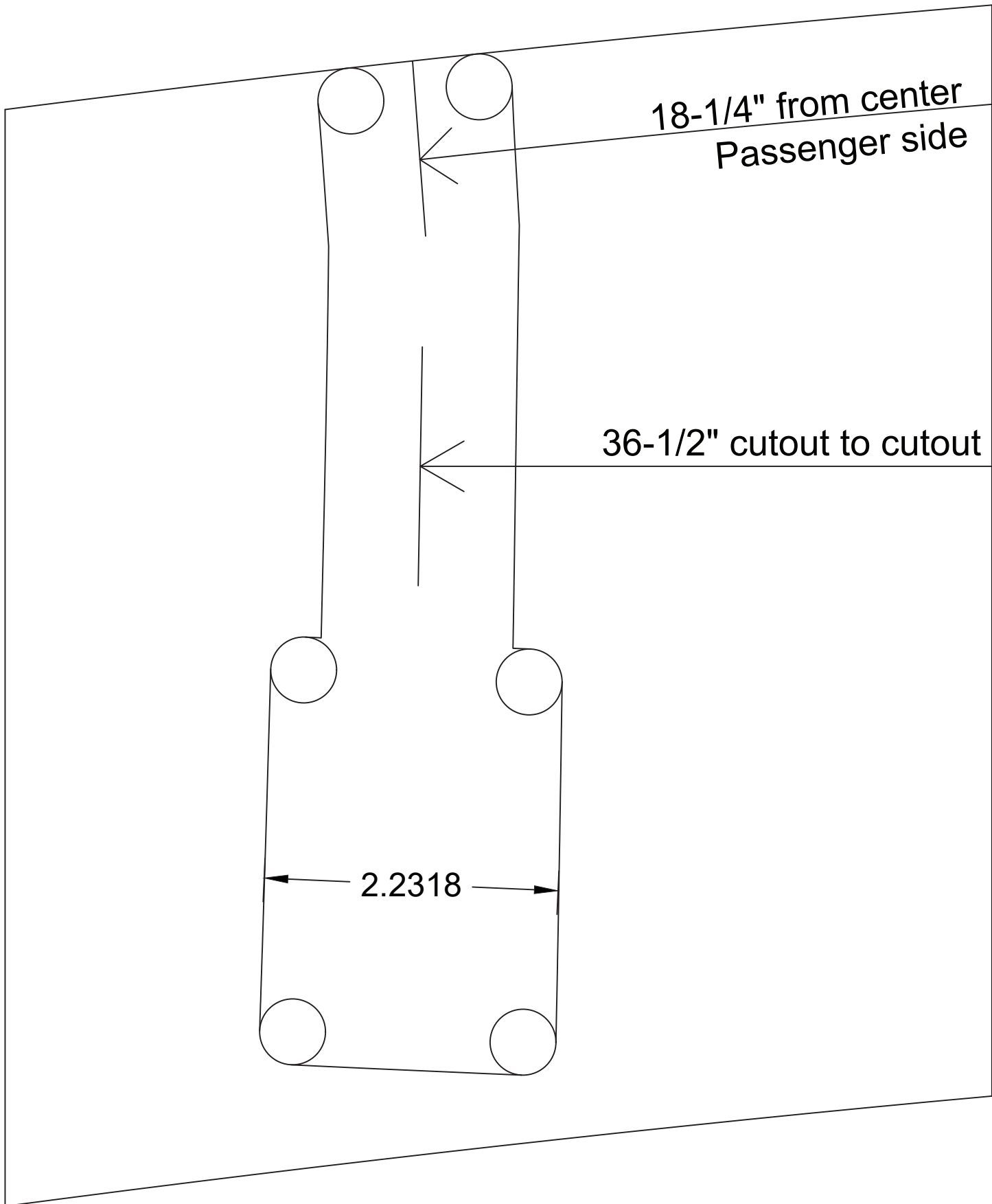

$18\frac{1}{4}$ " from center  
Passenger side

$36\frac{1}{2}$ " cutout to cutout

2.2318

## TOOLS NEED FOR INSTALLATION

- 1/2" IMPACT DRIVER
- 1/4" IMPACT DRIVER
- 18 MM WRENCH
- 15/16" WRENCH
- 1/2" DRILL BIT
- LARGE STRAIGHT BLADE SCREW DRIVER
- SMALL STRAIGHT BLADE SCREW DRIVER
- BUMPER CLIP REMOVER
- JIG SAW
- TORQUE WRENCH
- 1 1/8" DEEP SOCKET
- 15/16" SOCKET
- 8 MM SOCKET
- 3 MM SOCKET
- 16 MM SOCKET
- 18 MM SOCKET
- T-25 TORX BIT
- T-45 TORX BIT

## INCLUDED WITH THE GUARD AND BRACKET KIT

- QTY 2 - CV-19MSP-BR03SA GUARD BRACKETS
- QTY 2 - CV-19MSP-BR10 BRACKETS
- QTY 2 - 3/4"-9 LOCK NUT
- QTY 2 - CV-19MSP-BR06SA
- QTY 2 - M12-1.75X35 BOLTS
- CUT TEMPLATES

***IF AT ANY TIME YOU NEED HELP OR HAVE A QUESTION, PLEASE FEEL FREE TO GIVE US A CALL AT 888.902.2777 OR EMAIL US AT CUSTOMERCARE@EX-GUARD.COM***



**STEP 1:**  
REMOVE 4 BODY PINS FROM THE FENDER WELL, EACH SIDE USING THE PIN REMOVER.



**STEP 2:**  
REMOVE 2 BODY PINS EACH SIDE BOTTOM OF BUMPER



STEP 3:  
USING A FLAT SCREWDRIVER, RELEASE CLIP AS SHOWN. ACCESS VIA THE WHEEL-WELL.



STEP 4:  
PULL BUMPER SKIN AWAY FROM FENDER, ENOUGH TO REACH IN AND DISCONNECT THE DRIVING LIGHT CONNECTION AND PARKING ASSIST CONNECTION IF EQUIPPED.



STEP 5:  
REMOVE THE 3 SCREWS SECURING GRILL USING TORX BIT



STEP 6:  
PULL THE GRILL TOWARDS YOU, RELEASING THE ADDITIONAL CLIPS



**STEP 7:**

IF EQUIPPED WITH A FORWARD FACING CAMERA, RELEASE THE ELECTRICAL CONNECTION PRIOR TO REMOVING GRILL.

**STEP 8:**

REMOVE THE 2 BOLTS SECURING THE BOTTOM OF THE BUMPER





STEP 9:  
REMOVE THE 2 BOLTS SECURING THE TOP OF THE BUMPER

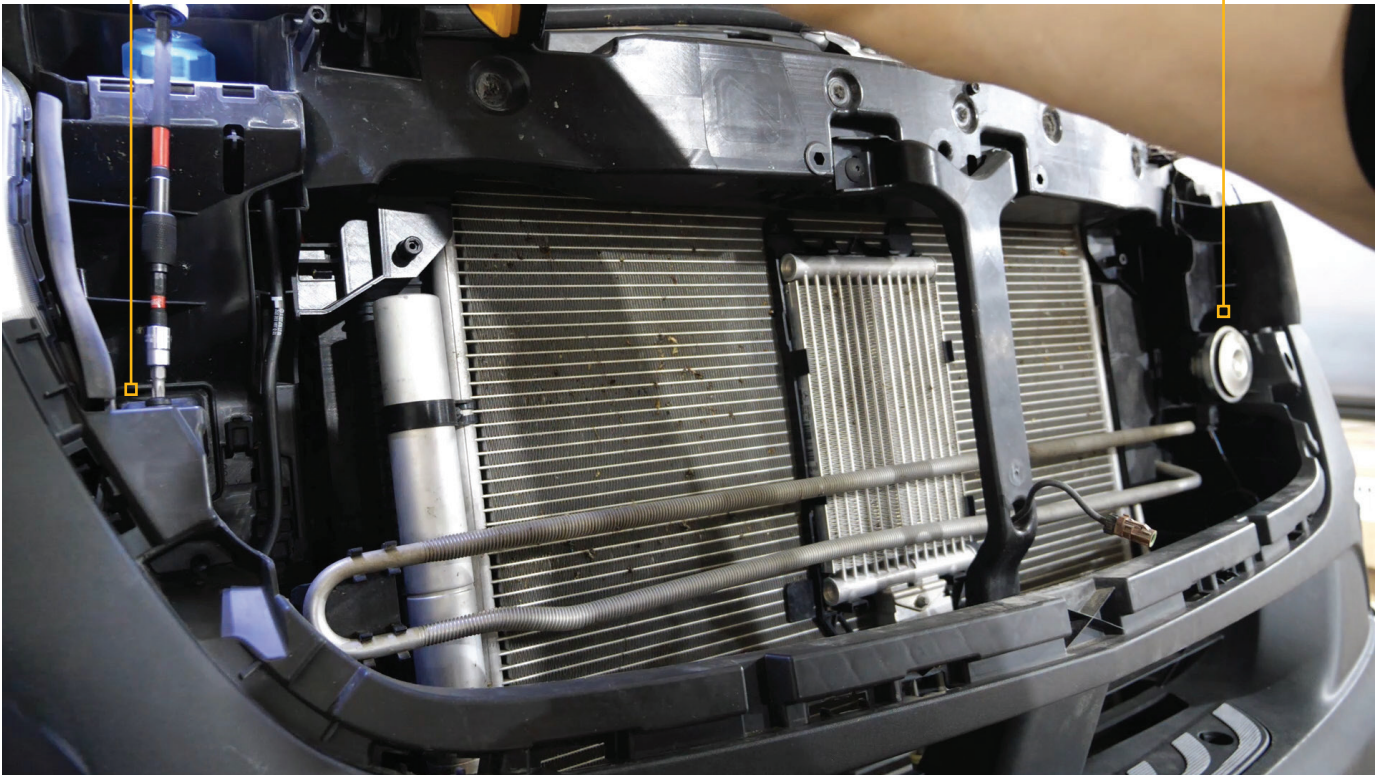

STEP 10:  
REMOVE THE BUMPER SKIN



STEP 11:  
 REMOVE THE CROSS BAR BY UNDOING 2 BOLTS EACH SIDE, THIS PIECE CAN BE  
 DISCARDED



STEP 12:  
 THERE IS A BOLT ON THE DEF TANK THAT NEEDS REMOVE TO PIVOT THE TANK OUT OF THE  
 WAY TO ACCESS THE BRACKET. PASSENGER SIDE ONLY



STEP 13:  
RELEASE CLIP

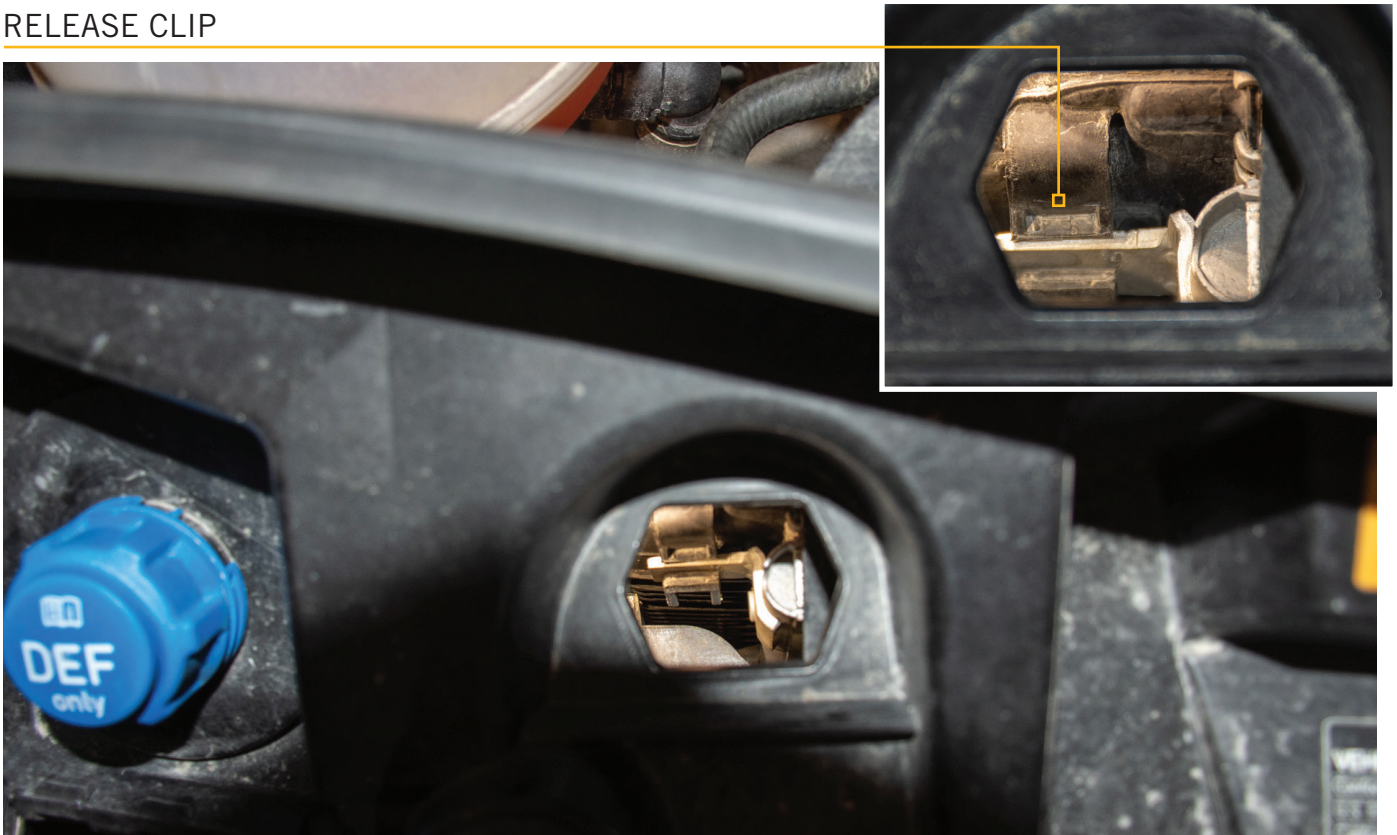

STEP 14:  
LIFTING THE COOLING RADIATOR REMOVE THE BOLT AS SEEN BELOW. THERE IS ONE BOLT PER SIDE.



STEP 15:  
PULL THE AIR COOLER DOWN, AND DISCONNECT THE HOSE



STEP 16:  
REMOVE THREE BOLTS SECURING FACTORY BRACKET



STEP 17:  
INSERT BRACKET ONTO FRAME, THREAD IN BOLT ON THE BOTTOM TO SECURE.



STEP 18:  
DRILL HOLE THROUGH FRAME ON THE SECOND LOCATION AS SEEN.



**STEP 19:**

INSERT WRENCH / NUT SUPPLIED THROUGH THE LARGER HOLE IN FRAME, AND POSITION NUT OVER NEW DRILLED HOLE. SECURE WITH SUPPLIED BOLT.

**STEP 20:**

INSERT BOLT ON THE SIDE AND FROM THE SIDE. TORQUE BOLTS TO 80FT/LBS



STEP 21:  
WHEN DONE INSTALLING BRACKET, REPOSITION DEF TANK AND SECURE.



STEP 22:  
REATTACH THE HOSE AND SECURE WITH CLIP.



REPEAT STEP 16 - STEP 20 ON DRIVER SIDE.

**STEP 23:**

MAKE A SMALL MARK ON THE LICENSE PLATE HOLDER TO MARK THE CENTER, THEN MEASURE OVER 18-1/4 INCHES AND PUT A SMALL MARK. POSITION THE TEMPLATE ON THE MARK AS SHOWN.





STEP 24:  
AREA TO CUT OUT SHOULD MEASURE 36-1/2" CENTER TO CENTER



STEP 25:  
DRILL A 1/2" HOLE ON EACH OF THE CIRCLE LOCATIONS ON THE TEMPLATE.



STEP 26:  
TAKE A JIG SAW AND CUT OUT PIECE TO REMOVE.



STEP 27:  
REINSTALL BUMPER SKIN



STEP 28:  
CUTOUPS SHOULD BE IN LINE WITH BRACKETS.



STEP 29:  
REINSTALL 2 FACTORY BOLTS ON LOWER BUMPER



STEP 30:  
REINSTALL 2 BOLTS SECURING TOP OF BUMPER SKIN

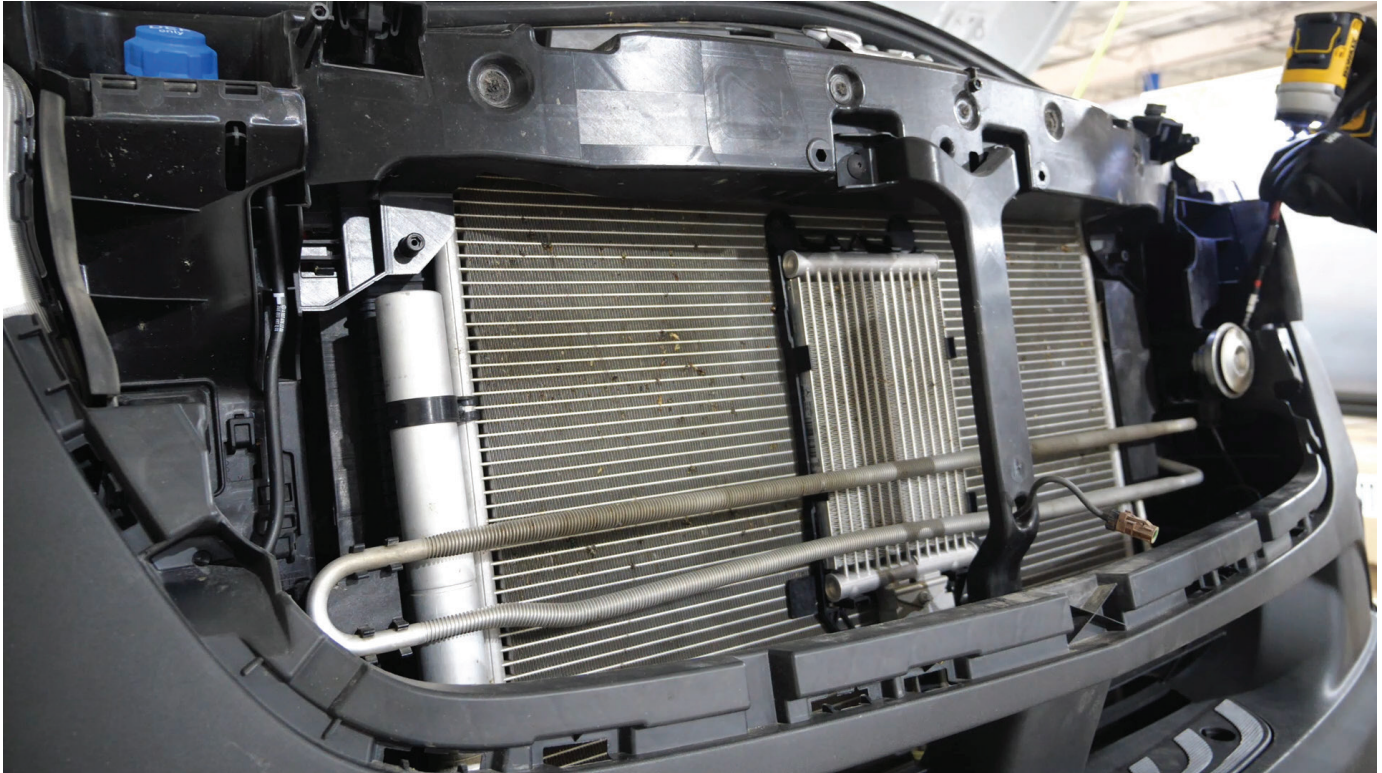

STEP 31:  
REINSTALL THE GRILL AND SCREW THE 3 SCREWS BACK INTO PLACE.



**STEP 32:**

INSTALL THE BRACKETS TO THE GUARD USING THE 5/8"-11 X 2-1/2" BOLTS AND THE 15/16" SOCKET AND WRENCH. MAKE SURE TO ATTACH THE BRACKETS TO THE CENTER OF THE UPRIGHTS.

**STEP 33:**

INSERT THE GUARD BRACKETS INTO THE VAN BRACKETS BY SLIDING INTO THE RECEIVER TUBE.



STEP 34:

INSTALL THE 3/4-10" FLANGE NUT BY USING THE 1-1/8" SOCKET. TORQUE TO 250 FT/LBS

