

## PARTS LIST - XG-19ILTE\_REV1

**TOWING CAPACITY PER PAIR: 80,000LBS TRUCK AND TRAILER**

**BOLT KIT - XG-BRK14, XG-BRK7**

### COMPATIBLE GUARDS

- XG-100, XG-125, XG-150
- LT-325, LT-350
- HD-425, HD-450

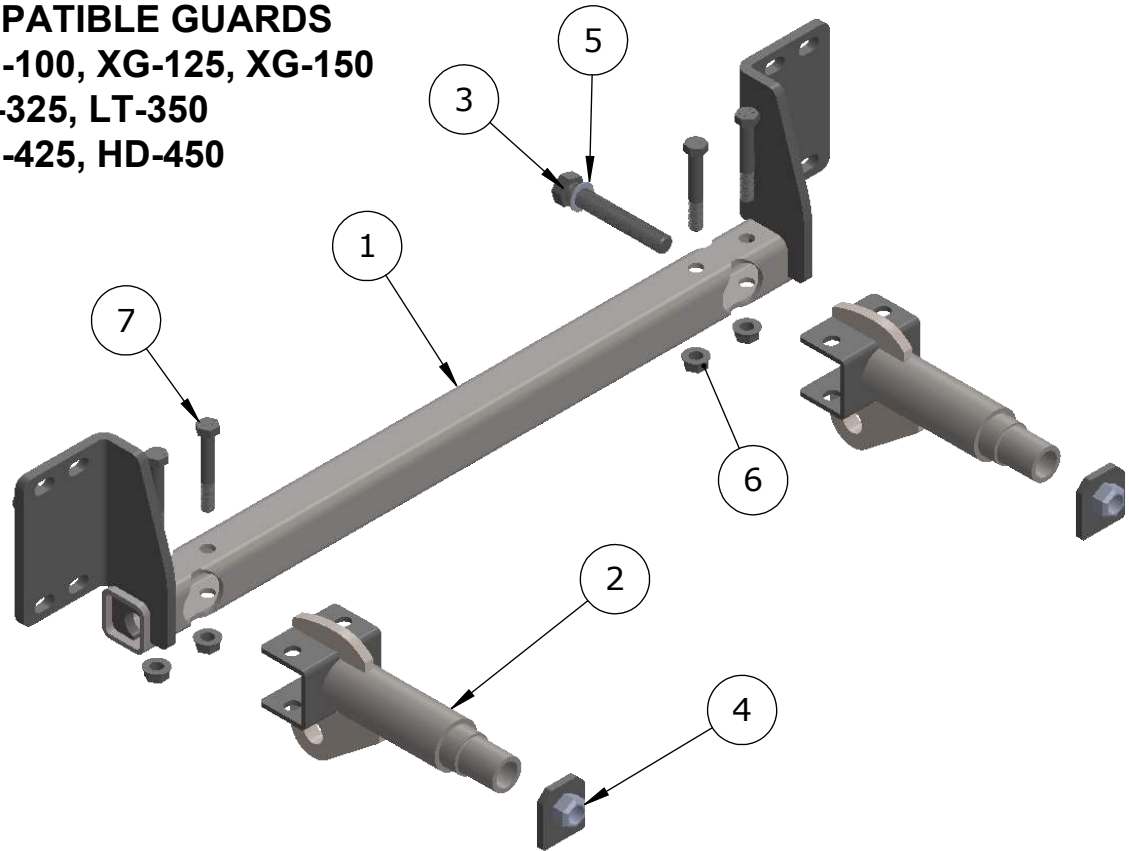

ITEM NO.	PART NUMBER	DESCRIPTION	QTY.
1	XG-19ILT-BR05SA	CROSSBAR FOR XG-19ILT/E	1
2	XG-19ILTE-BR10_REV1	MOUNTING BRACKET XG-19ILTE	2
3	XG-001-87C550HCS8Y	7/8-9 X 5.5 HEX BOLT	2
4	XG-17ILTE-BR08	BACKUP WASHER W/ NUT	2
5	XG-001-87NWMD0Y	7/8" GRADE 8 FLAT WASHER	2
6	XG-001-62CNWF0Z_HARD	5/8-11 Serr FlangeIn Hard ZINC	4
7	XG-001-62C400HCS8Y	5/8-11 x 4 Hex Bolt	4

**ATTENTION!! Any Ex-Guard grille guard, bracket kit, or hardware must be used with corresponding Ex-Guard components. Use of any other product or brand with Ex-Guard products will immediately void the warranty provided by Ex-Guard Industries.**

# MOUNTING INSTRUCTIONS - XG-19ILTE MTS INS\_REV1

## INTERNATIONAL PROSTAR AND LT SERIES WITH STEEL BUMPER

CALL FOR (888) 902-2777 FOR INSTALLATION QUESTIONS OR EMAIL [INFO@EX-GUARD.COM](mailto:INFO@EX-GUARD.COM)

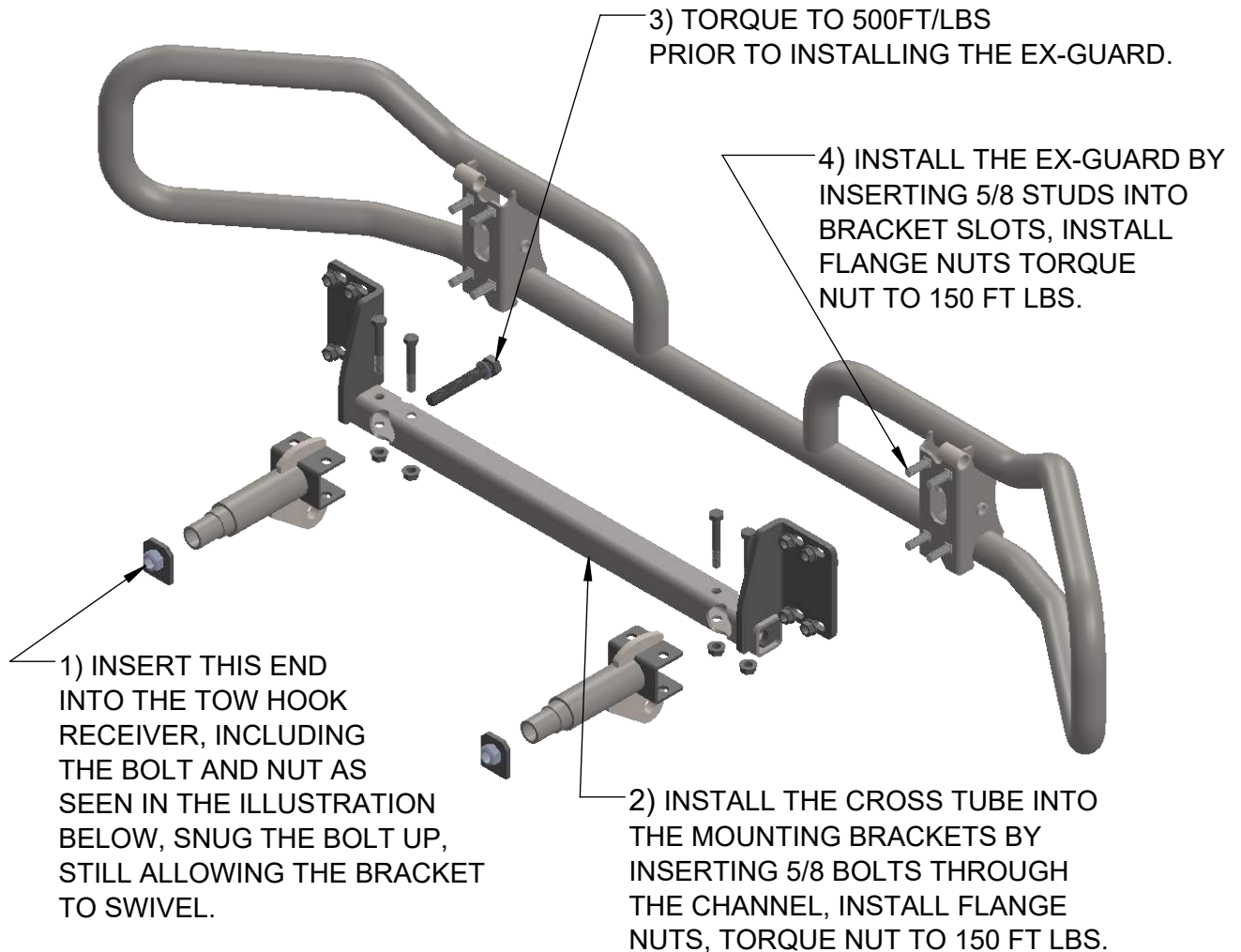

**IMPORTANT!! Any Ex-Guard grille guard, bracket kit, or hardware must be used with corresponding Ex-Guard components. Use of any other product or brand with Ex-Guard products will immediately void the warranty provided by Ex-Guard Industries.**

©THIS DRAWING IS THE PROPERTY OF EX-GUARD INDUSTRIES, INC. COPYRIGHT IS RESERVED BY THEM AND THE DRAWING ISSUED ON CONDITION THAT IT MUST NOT BE USED FOR ANY OTHER PURPOSE OTHER THAN FOR WHICH IT WAS SUPPLIED AND NOT TO BE COPIED, REPRODUCED, RETAINED OR DISCLOSED TO ANY UNAUTHORIZED PERSON EITHER WHOLLY OR IN PART WITHOUT THE CONSENT IN WRITING OF EX-GUARD INDUSTRIES INC.